

USER MANUAL

E-bidet

Thank you for your trust.

Thank you for purchasing products. Before using the product, you can learn from this manual about important items, such as the product use methods.

Please follow the notes in this manual.

Please keep the manual properly after reading for later reference.

Due to the continuous improvement of the company's products, the products are subject to change without notice. The illustrations in this manual are only schematic diagrams, and please refer to the product in kind.

We look forward to your ability to know the product use methods through this manual.

In order to ensure that the product can provide the best function and guarantee your personal safety, you are suggested to read this manual carefully before first use.

Contents

Safety notes	1	Before use
Use precautions	4	
Product description	5	
Component description	6	
Installation steps	7	Installation and use
Function introduction	10	
Optional description	12	
Cleaning and maintenance	13	Other matters
Faults and solutions	15	
Product dimension drawing	16	
Product technical specification	17	
Warranty Card	18	

Safety notes

Read the safety instructions carefully before use so as to properly use the product. Note the following warnings relevant to the safety.



Warning



Prohibition



Compulsory observance



Note

Failure to operate pursuant to the above-mentioned warning signs may result in injury or life-threatening risk.

People (including children) who are deficient in body, perception, intellectual capacity, or experience and common sense (including children) are cognized. Limited ability and/or lack of knowledge necessary to use the device without supervision. In addition to, they were given custody or guidance on the use of the product by those responsible for their safety. Without the The child of the tube shall not use the equipment alone, and ensure that children cannot play with instruments.



Avoid water splashing on the product.

- May result in fire or electric shock.

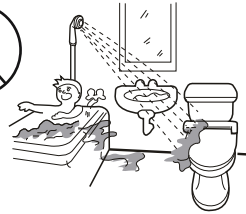
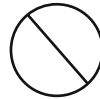

Grounding

Check if the 3-pole grounding structure is grounded.

- 3-pole grounding structure must be grounded, or otherwise the product failure or electricity leakage will occur.



Compulsory observance

The power cord of this product is Y-type connection. if the power cord is damaged, it must be replaced by the manufacturer or technicians to avoid dangers



Safety notes

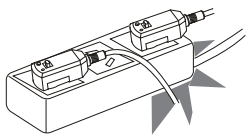
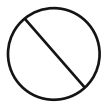

Only suitable for the power in technical specification; It is strictly prohibited to use excessive loads on the same socket.

- May result in overheating or fire.

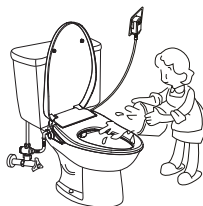
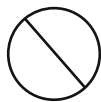

Ensure that the water, cleaning agent or urine does not wet the power plug.

- May result in fire or electric shock.

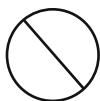

Do not pull the power plug/ power cord at will.

- May result in fire or electric shock.

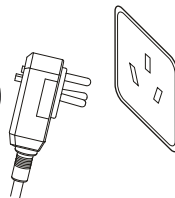
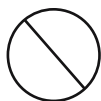

Do not use a loose socket.

- May result in fire or electric shock.

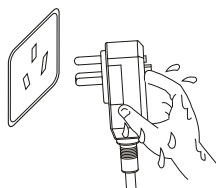
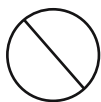

Do not plug/ pull the power plug when the hand is wet.

- May result in electric shock.

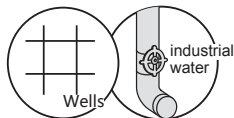
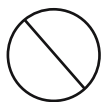

Do not connect to the substandard water pipe.

- May result in skin infections or product damage.

Safety notes

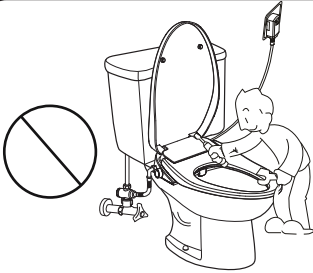

Do not disassemble, repair and modify products by without authorization.

- May result in fire or electric shock.

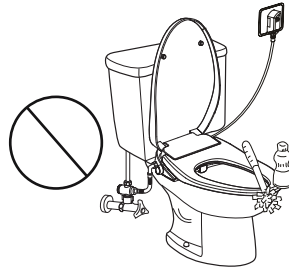

Please unplug the power supply when cleaning the product.

- May result in electric shock.



Please don't keep the lighted cigarette or other combustion items near the product

- May result in fire.

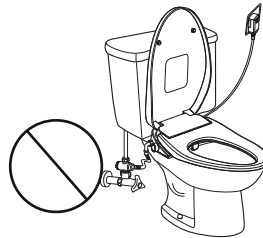

Do not bend or twist the water supply hose.

- May result in water leakage.

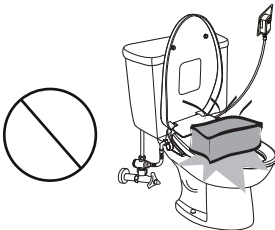

Do not place heavy objects on the toilet seat or the toilet cover

- May result product damage.

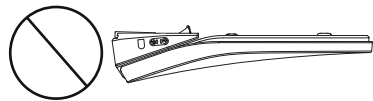

Do not invert product.

- May result in product damage.



Please clean with the diluted kitchen cleaning agent and do not use the following items:
Benzene, paint thinner, detergent powder, nylon brush, etc.

- May result in product damage.

Use precautions

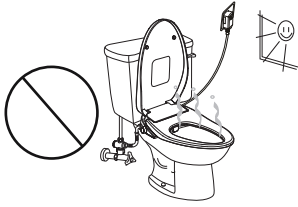

Do not place this product in direct sunlight.

- It may cause product discoloration and failure of seat heating function.



The room temperature of toilet shall be above 0°C.

- Otherwise, it is possible to freeze the product. Use warm air and other methods to improve the temperature in the toilet.

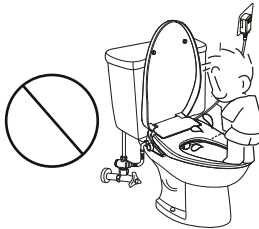

Do not shower urine on the bidet body and nozzle.

- May result in blockage.

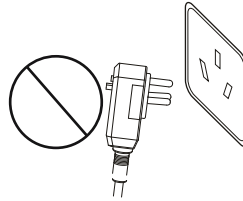

Please not use substandard power supply.

- May cause product failure.

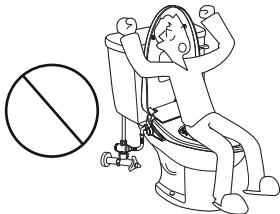

Do not lean against the toilet lid when in use

- May cause damage to the toilet lid.

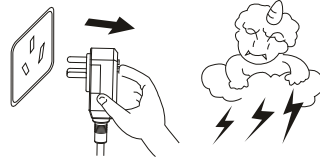

Pull off the power plug when lightning strikes.

- May result in product failure or damage.



When not in use for a long time, drain the stored water and pull the plug.

- Otherwise, water pollution and skin infections may be caused.

Product description

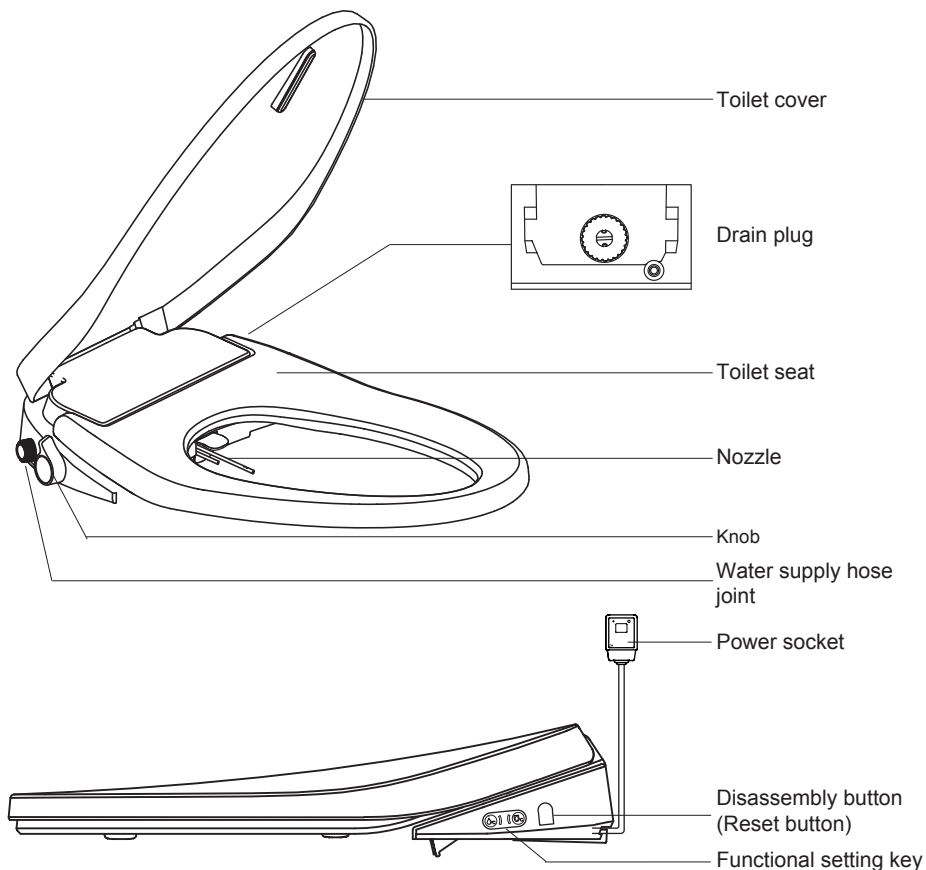

Functional setting key

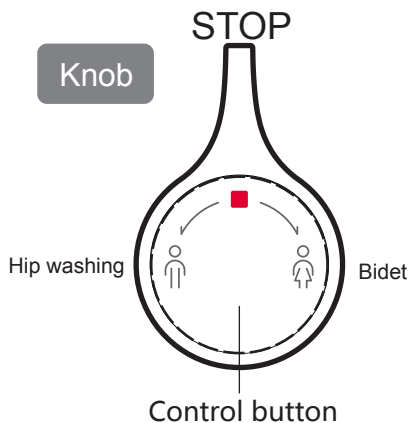
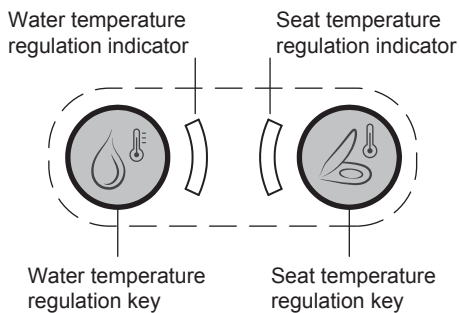

Component description

1. Cover plate

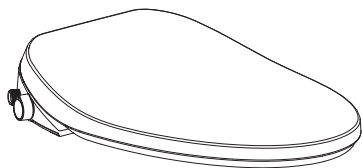

2. Installation template

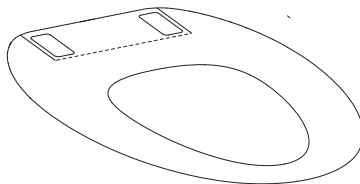

3. Fixation part



Connecting bolt (2)



Adjustment sheet (2)



Plastic TAB(2)

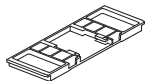

Fixing plate



Rubber bushing(2)

4. T-junction

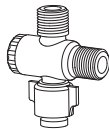

5. Water inlet hose



Filter screen

6. User manual

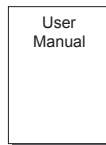

Installation steps

• Installation tools



Cross screwdriver

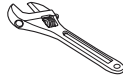

Monkey wrench



Barrel and rag

• Attention before installation

1. Water pressure range: 0.1-0.75MPa, please follow the instructions.
2. Corner valves shall be located close to the location where this product is installed and disassembled.
3. Please use the braided hose that comes with the product to prevent water leakage.
4. When installing braided hose, be careful to prevent the black gasket falling out.

• Installation Procedure

1. Loosen the nut connecting and remove the old cover.



2. Place the mounting template on the ceramic as shown. Align it with the rim of toilet.

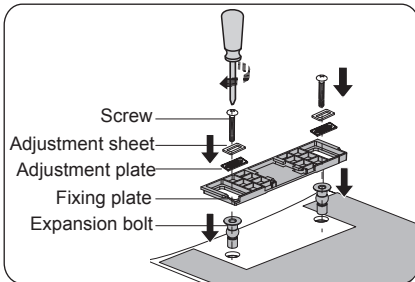
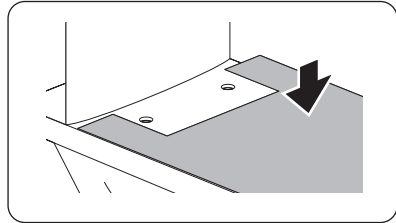

3. ① Insert the expansion bolt into ceramic hole;
② Place fixing plate in notch part of template;
③ Place adjusting sheet and plate in fixing plate;
④ Align expansion bolt hole, and tighten up;

4. To insure function of product, please press the reset button before you installation

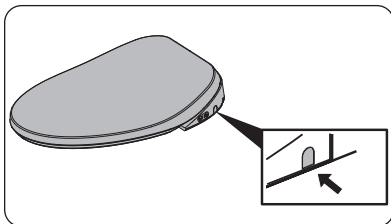

5. Slightly push the cover into fixing plate until you heard "click", indicating that the cover has been installed in place.

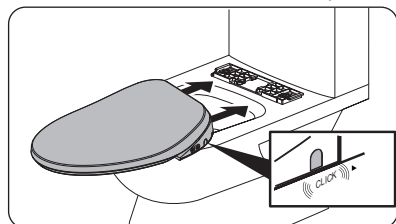

Installation steps

6. Close the water valve;

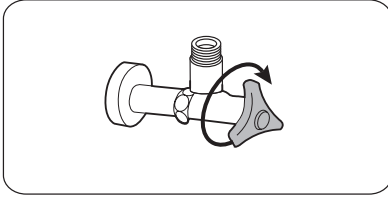

7. Install braided hose;

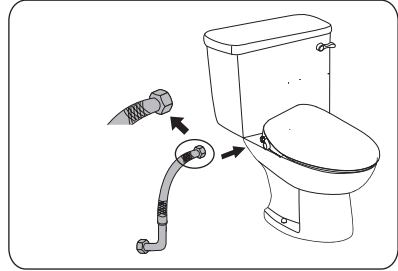

① When the ceramic is similar to the figure above, we suggest connecting the straight end of the hose to the cover

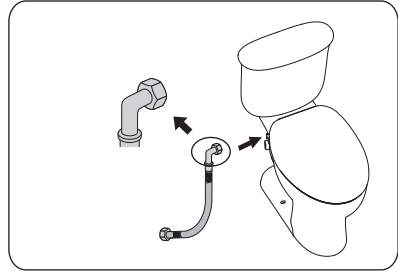
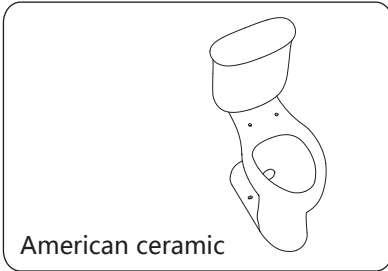

① When the ceramic is similar to the figure above, we suggest connecting the elbow end of the hose to the cover

8. Installation tee;

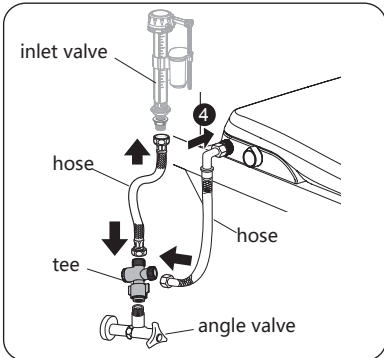

Normally, the tee is installed on the angle valve

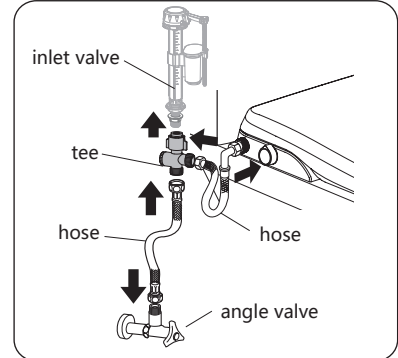

if the angle valve and wall is too close, you can installed the tee under the inlet valve

Installation steps

9. Open the angle valve to check for water leakage;

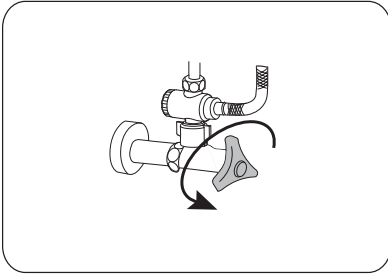

10. Turn on the knob to check whether the nozzle is protruding;

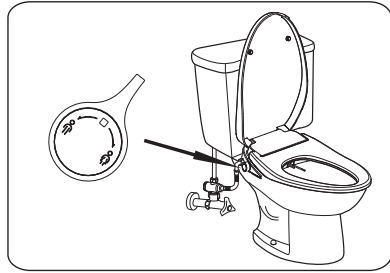

11. Plugged into a power supply;



Note

In order to protect the internal circuit, be sure to turn on the knob to make the nozzle out before plugged into power



Prohibition

1. It is strictly prohibited to move the product from the toilet cover, otherwise easy to cause mechanical failure.
2. It is strictly prohibited to connect hot water above 40 °C and cold water that may lead to icing.

Function introduction

• Standby mode

1. Make sure the plug is dry before power supply is connected.
2. After the power supply is connected, the "bi" indicates that the cover can be used normally.
3. Water temperature by default at low gear position: about 35°C.
4. Seat temperature by default at low gear position: about 33°C.
5. After the power supply is connected, the knob light and night light are constantly on

• Konob functin

1. Rinse functin

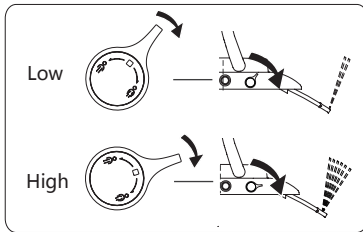

Bidet/Hip rinsing

Rotating knob to adjust amount of water

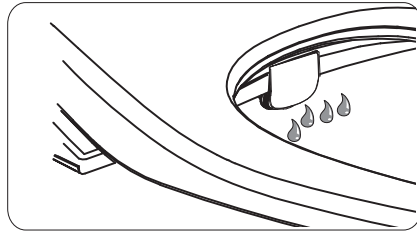

Nozzle self-cleaning

Turn on the knob to rinsing, the nozzle will self-cleaning for 5s, then switch to rinsing

Note: Please open the knob to the maximum before use, and then adjust the amount of water and rinsing force through the knob.

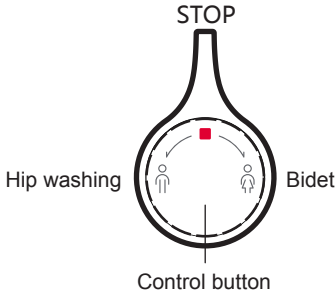

Knob light will flash when rinsing

Knob light

2. Massage rinse

When rinsing, press the control button to open the massage rinsing, if you finish rinsing, press the button again to close the massage rinse

3. Light control

Hold the button to control the light cycle

Mode 1 (Default)	knob light on, night light on	There is a beep prompt during the switching
Mode 2	knob light off, night light on	
Mode 3	knob light off, night light off	

Function introduction

• Functional setting instructions

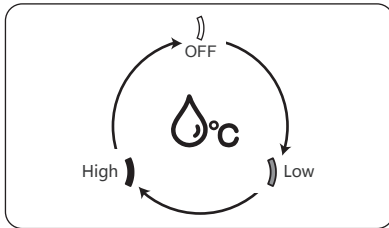
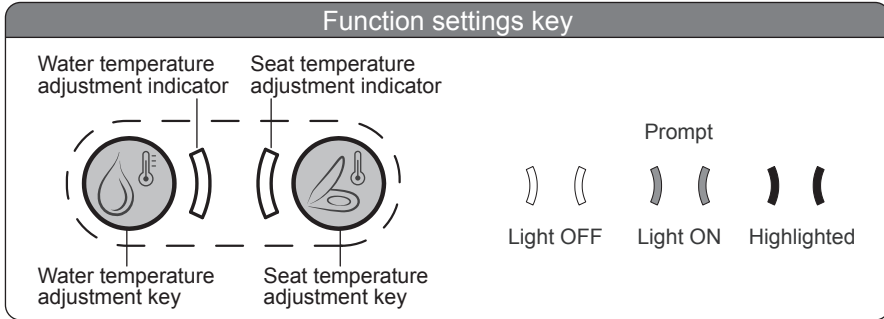

- Repeatedly press “ $\Delta^{\circ}\text{C}$ ” will switch over water temperature in the sequence indicated in the left figure.
- When you turn off the water temperature you will heard two seconds "bi";When you switchover there will be one second "bi".
- Water temperature low gear: about 35°C. Water temperature high gear: about 38°C.

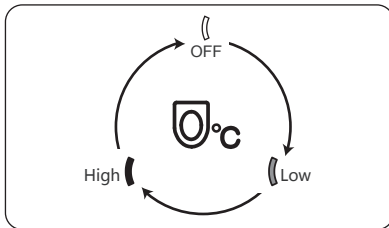

- Repeatedly press “ O°C ” will switch over water temperature in the sequence indicated in the left figure.
- When you turn off the water temperature you will heard two seconds "bi";When you switchover there will be one second "bi".
- Seat temperature low gear: about 33°C. Seat temperature high gear: about 37°C.

• Protection functions:

1. Anti-splash function:

when the knob is not completely closed, it will alarm and automatically switch to self-cleaning mode.

2. Water temperature protection function

(1)When the water temperature exceeds 43°C, it will automatically switch to self-cleaning mode.

(2)At this time,it must be reconnected to the power supply .

3. Low temperature scalding protection function:

After the body is seated by 5min, the seat temperature will automatically switch to about 29°C .

• Normal use during power failure

The water temperature and seat temperature cannot be adjusted when the power supply for product is cut off, but the flushing with normal temperature can be used normally.

Optional description

•Optional description

According to the actual demand,the product provides different configuration scheme

Name	Function	Description
Control button	<ol style="list-style-type: none"> 1、 control light 2、 control rinse 3、 control warm wind 	 <p>Without this configuration,the knob light is cancelled and night light can be controlled by pressing two function keys at same time</p>
Booster module	<ol style="list-style-type: none"> 1、 booster 2、 massage rinse 	Without this configuration,no massage rinse
seat sensor	<ol style="list-style-type: none"> 1、 Low temperature scalding protection 2、 Anti-splash function 	<ol style="list-style-type: none"> 1.Without this configuration,seat do not has low temperature scalding protection 2.When the knob is not completely closed, it will always splash
warm wind module	Warm wind	Without this configuration,no warm wind



Note

The specific functions shall be subject to the actual products

Cleaning and maintenance

• Manual cleaning of spray tube

- Gently pull out the nozzle and dip the neutral detergent with a soft cloth, sponge or small brush.
- Gently support the nozzle, wipe the spray tube and nozzle.

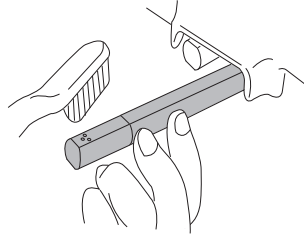

• Clean filter screen

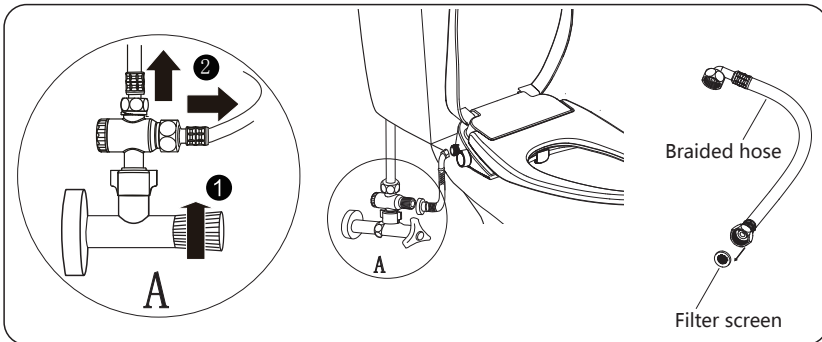

i Tips:

- Make sure that the corner valve close and the power off before you clean the filter screen ;
- Clean the filter screen when the water flow is less than normal hours.
- During cleaning process, the product must be thoroughly separated from the water inlet hose;
- Reinstall the filter screen in reverse order after cleaning.

• Product surface cleaning

⚠ Note: Please cut off power supply before cleaning.

- Wipe the product surface with a sponge or soft cloth dampened with room temperature water or a neutral detergent.
- Lift the upper cover and the seat ring when cleaning other parts with cleaning agents.
- Do not put cover on before the cleaning agent in the ceramic toilet is completely washed, otherwise the surface may be corroded by the evaporation of cleaning agent.

Cleaning and maintenance

• Leakage protector

Check the leakage protector regularly, at least once a month .
Inspection method:

- Press leakage protector Reset, the indicator light is on, and the power supply is on.
- Press the "Test" key of leakage protector, the indicator light is off, and the power supply is disconnected.
- When the operation is completed, the corresponding error indication information appears, stop using the product, contact the local supplier or call the service hotline to replace the leakage protector.
- Please ensure that the leakage protector indicator light is always on when the product is operating.
- If the leakage protector is already installed in the line, check it in the manner described above.

► Schematic diagram of leakage protector:

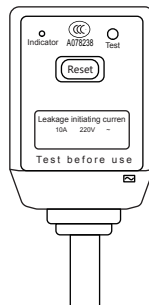

• Product maintenance in winter

when the temperature of toilet below 0 C :

- Pull out the power plug or press the "Test" key of leakage protector.
- Remove water inlet hose from the angle valve to the toilet end, and empty the water in the water inlet hose;
- Remove the bottom nut,and drain internal water.

• Not use in a long time

When this product is not used for a long time, drain the water in the product and cut off the power supply:

- Pull out the power plug or press the "Test" key of leakage protector.
- Close angle valve and stop the water inlet.
- Remove water inlet hose from the angle valve to the toilet end, and empty the water in the water inlet hose.
- Close the upper cover, press and hold the removal button by hand, move the electronic seat cover from the front, and then complete the removal.
- Place the cover in a cool and dry place when not in use for a long time.

Faults and solutions

• Common fault diagnosis

When you think it is a fault, try some of the following processing methods. If the product is still not working properly, contact your local repair center or call the service hotline.	
Check power supply 1.If power supply is under normal state. 2.If leakage protector trips 3.Manual reset thermostat(Installation step4)	Check water supply 1.If water supply is under normal state. 2.If corner valve is closed.
If the following occurs, cut off the power supply immediately.	
The leakage protector trips frequently	

⚠ Note: When water leakage occurs, close the angle valve and cut off the power supply.

• Water leakage analysis

Phenomenon	Possible cause	Solution
When person leaves the seat, the product alarm and water outlet continues to leak	Knob is not close	Close the knob
	Control valve is failed	Cut off the power supply, close the angle valve and contact the after-sales department for replacement.

• Analysis of seat heating failure

Phenomenon	Possible cause	Solution
Seat temperature is not sufficient	Seat temperature is set at low gear	Adjust seat temperature to higher gear.
Seat temperature is too high	Seat temperature is set at high gear	Adjust seat temperature to lower gear.
Temperature is too low when just contact with seat	Not enable seat heating function	Enable seat heating function in advance.
No seat heating function	Seat heating coil in poor contact	Cut off power supply, contact the after-sales department for replacement.

• Flushing failure analysis

Phenomenon	Possible cause	Solution
Spray tube extends too slowly	Cool water should be released from front end before flushing.	It is normal, and provides normal flushing about 5s later.
Insufficient water amount	Knob is not completely turned on.	Increase knob regulating angle.
Water temperature too low	Water temperature is set at low gear.	Adjust water temperature to higher gear.
	Automatic protection for over-high temperature	Restart water temperature adjustment.
Water is not heated Breathing light not flash	The flowmeter is abnormal	Cut off power supply, contact the after-sales department for replacement.
The product continues to alarm and all functions fail	Trigger security protection or product failure	Reconnect to the power supply, if the fault still exists contact the after-sales department for replacement

• Night light analysis

Phenomenon	Possible cause	
Night light is not ON.	Night light is turned off or damaged	Reconnect to the power supply, if the fault still exists contact the after-sales department for replacement
Knob light is not ON	Knob light is turned off or damaged	

Product dimension drawing

- Product dimension drawing

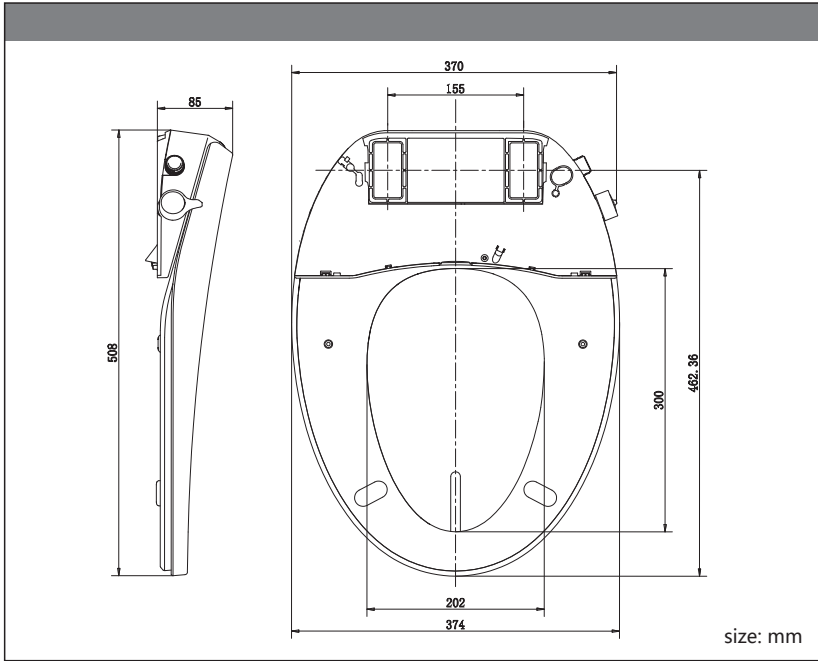

Product technical specification

Items		Description
Model		
Rated voltage		120V~, 60Hz
Rated power		1050W (Inlet water temperature 15±5°C, flow at 600ml/min)
Max. transient power		1550W
Length of power line		Default ≥ 1.5m
Water supply pressure		0.1 ~ 0.75MPa
Water supply temperature		5 ~ 35°C
Ambient temperature		0 ~ 40°C
Net weight		About 3.2kg
Package dimensions		545×410×130mm
Water proof grade		IPX4
Cleaning device	Water amount regulation	Stepless regulation
	Water temperature regulation	Gear 3: about 35/38 C/OFF
	Heating method	Instant heating
	Anti-backflow device	Anti-siphon valve
	Safety device	Double thermostat
Seat heating	Surface temperature	Gear 3: about 33/37 C/OFF
	Heater power	50W
	Safety device	thermostat & fuse
Others	Massage rinse	Optional
	Antibacterial material	Nozzle and seat
	Low temperature scalding protection	Optional
	Abnormality prompt	Alarm sound
	Control operation	Knob
	Auxiliary key	Water temperature and seat temperature setting
	Seat sense	Optional
	Light control	Optional

Warranty Card

To dear customers:

Thank you for choosing our E-bidet! If any problem occurs during use, please simply remove and check the problems pursuant to the user's manual. When you cannot remove such problems, contact your local supplier or call the service hotline.

I. Information:

Customer information	Customer name		
	Address		
	TEL		
Dealer information	Name		
	TEL		
Model		Product series number	
Purchase date	Y	M	D
		Warranty period	One-year free warranty since the purchase date

II. Notes to warranty card:

1. Please complete the warranty card.
2. Warranty cards and invoices are important for the warranty service.
If the product failure occurs during warranty period, please show the warranty card and the invoice when the dealer or after-sales service personnel of the Company provide on-site maintenance and repair.
3. The warranty card cannot be reissued, please keep it properly.

III. Rules on free maintenance

During the warranty period, the Company will provide repair free of charge according to the use instructions, precautions for normal use.

IV. Paid maintenance is required in the following circumstances that do not fall within the scope of free maintenance:

1. Out of warranty.
2. The valid invoice and warranty card cannot be provided during the warranty period.
3. Failure or damage caused by transportation, collision after purchase.
4. Product damage during abnormal use, failure and damage during the warranty period caused by human factors or natural disasters, such as fire, earthquake, flood, lightning or environmental pollution, etc.
5. Failure or damage caused by unauthorized disassembly, modification or maintenance due to user's cause or responsibility.
6. Failure or damage caused by violation of maintenance regulations in use, such as improper use of cleaning agent or wiping and maintenance methods not compliant with maintenance requirements.
7. The consumable items (such as sealing rings, etc.) or products have failed or damaged due to sand and impurities.
8. Conduct the secondary transfer according to the customer's requirements.



